

## Painting Rotation Schedule—Working Clockwise

North Face: 3/5—4/13

East Face: 4/11—5/15

South Face: 5/16—6/19

West Face: 6/20—7/10 (areas not previously painted)

1st and 2nd Floors and Town Homes: 7/11—8/14

*\* Tentative Schedule—Subject to Change due to Weather or Timing \**

### NORTH FACE SCHEDULE FOR NORTH & SOUTH TOWERS

(Units Facing Market Street)

**STEP 1: Power Washing Entire North Face 3/5/18—3/13/18**

**All Units in all Drops shown below are affected. Remove items from balcony.**

**STEP 2: Painting & Repairs per drop from 8 AM – 4:30 PM**

#### Drops & Dates

**Drop 1: 3/12 - 3/16—Starting at West End of the NORTH FACE OF BOTH TOWERS**

**Units: 1804, 1904, 2004, 2204, 2402, 2502 & 05 UNITS—305, 405, 505, 605, 705, 805, 905, 1005, 1105, 1205, 1305, 1405, 1505, 1605, & 1705.**

**Drop 2: 3/16-3/26 & Drop 3: 3/26-3/30**

**Units for Drop 2 & 3:**

**1804, 1904, 2004, 2204, 2402, 2502, 01, & 05 UNITS—301, 401, 501, 601, 701, 801, 901, 1001, 1101, 1201, 1301, 1401, 1501, 1601, 1701, 1801, 1901, 2001, 2101, 2201, 2301, 2401, & 2501. 305, 405, 505, 605, 705, 805, 905, 1005, 1105, 1205, 1305, 1405, 1505, 1605, & 1705.**

**Drop 4: 3/30-4/13**

**Units: 01 UNITS—301, 401, 501, 601, 701, 801, 901, 1001, 1101, 1201, 1301, 1401, 1501, 1601, 1701, 1801, 1901, 2001, 2101, 2201, 2301, 2401, & 2501.**

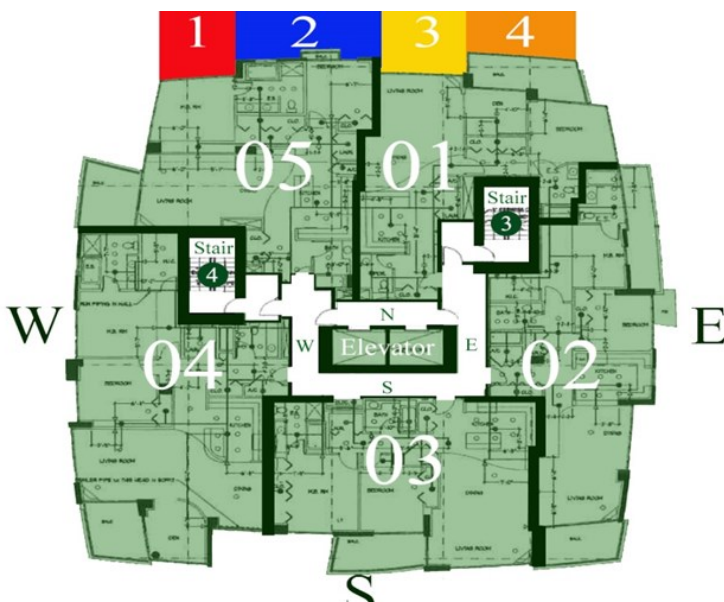

**Please remove all balcony items to avoid a \$500 charge for painters to return a second time. Large heavy tables should be moved away from the balcony walls and covered if needed.**

Please contact Southern Cross Property Consultants – Project Manager Robert Porter at (619) 733-3051 or [robert@southerncrosspc.com](mailto:robert@southerncrosspc.com) with any questions or concerns.

*If you are out of town and need assistance in removing items from your balcony, please contact Management at (619) 338-4096 or [mdouglas@actionlife.com](mailto:mdouglas@actionlife.com).*